



SUBARU GENUINE SPOILER INSTALLATION INSTRUCTIONS
APPLICABLE VEHICLE: SUBARU LEGACY WAGON

PART NO: E7210LS000## (PAINTED)



Content:

| No. | Part Name | Qty. |
|-----|---------------------------|------|
| 1 | Roof Spoiler | 1 |
| 2 | M6- Mounting Bolt | 2 |
| 3 | M6- Mounting Nut | 2 |
| 4 | Installation Instructions | 1 |
| 5 | RH Locating Template | 1 |
| 6 | LH Locating Template | 1 |

Tool and Material Requirement:

Screw Driver, 10mm Nut Driver, 10mm 1/4" Drive Socket, 1/4" Drive Extension, 1/4" Drive Ratchet, Power Drill, Drill Stop, Torque Wrench, Drill Bits: 3 mm (1/8"), 8 mm (5/16"), 10mm (25/64"), Felt Marker, Center Punch, Hammer, Touch Up Paint or Silicone and Adhesive Tape

General Notes for Installation:

1. Take care not to damage the the roof spoiler during handling and installation.
2. Wipe off transit coating, dust, stains, oils, etc. on the mating surface of the rear gate with neutral detergent.
3. Since precise hole locations are critical for easy installation and correct fit, carefully locate the templates.

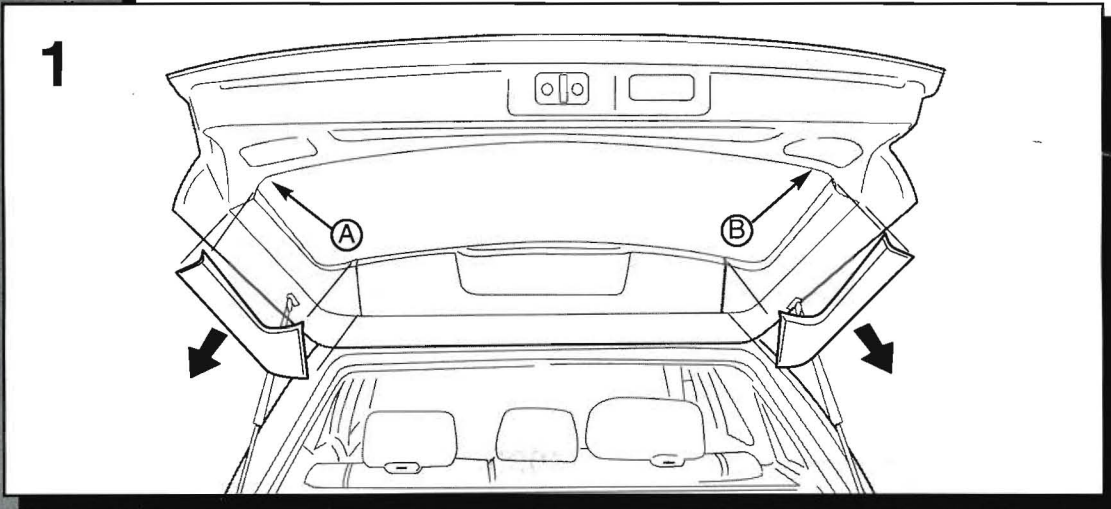

- 1**
1. Open the rear hatch and cover compartment area with a blanket to keep clean.
 2. Release the lower interior panel by pulling down at corner area of points "A" and "B" to disengage the attaching clips.
 3. Remove the two window pillar trim pieces by loosening at both ends and pulling in direction shown in Figure 1 to release the side trim panels.
- NOTE:** It is not necessary to remove the upper trim piece adjacent to the Stop Lamp.
4. Close hatch.

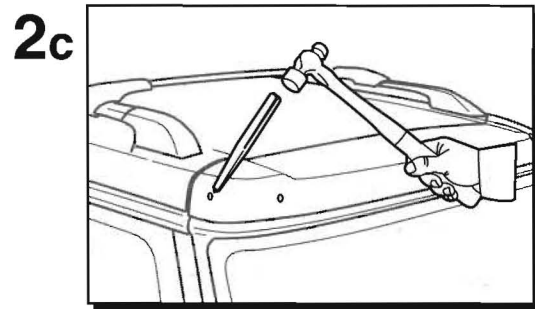
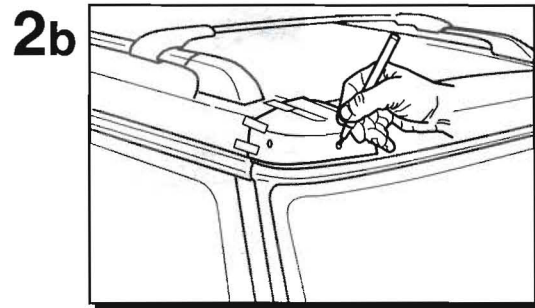
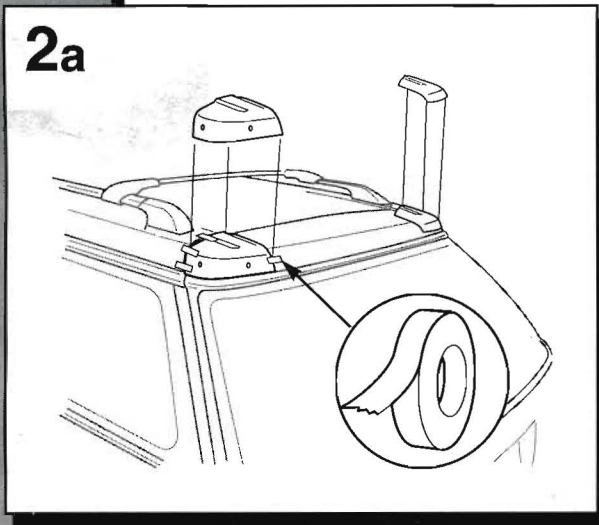

- 2a**
1. Tightly fit the template to upper portion of the rear hatch (Fig. 2a) and tape into position with adhesive tape. Make sure there are no gaps between the template and the vehicle.
 2. Mark the rear hatch through the small (3 mm) holes of the templates at LH 2 places and RH 2 places. (Fig. 2b)
 3. Remove the templates from the rear gate.
 4. Center punch the marked locations at all four locations. (Fig. 2c)
- NOTE:** To avoid denting the rear hatch, a sharp center punch must be used.

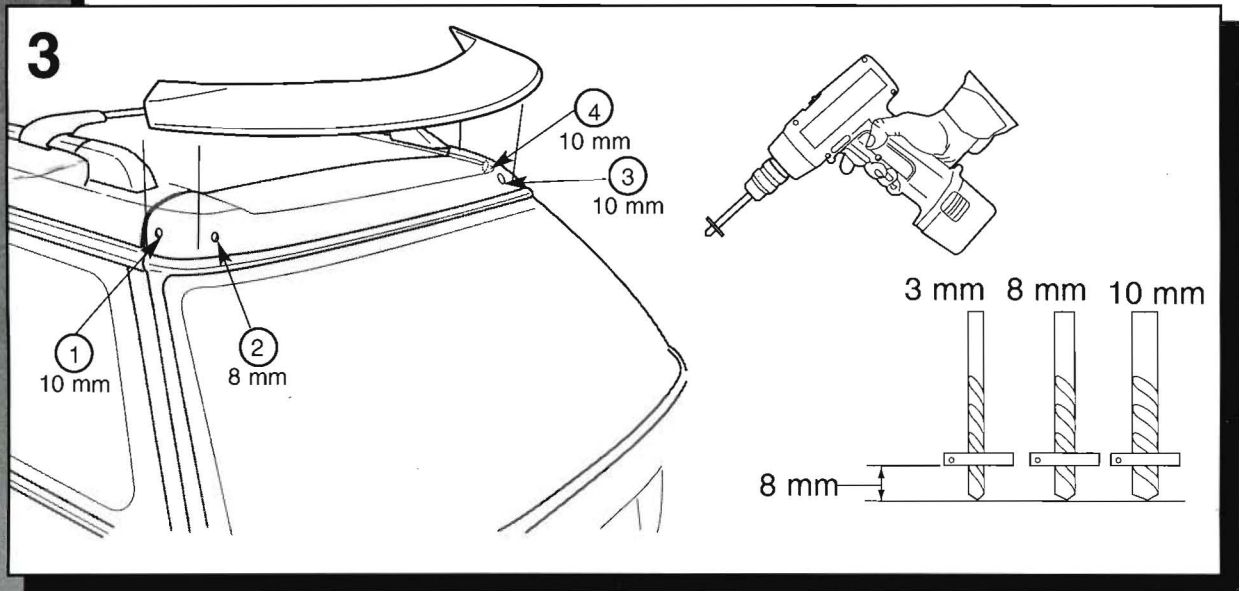

- 3**
1. Set drill stop to 8 mm (5/16"). This is important to avoid contact with the vehicle wire harness.
 2. Drill 3 mm pilot hole. (4 places, at locations 1, 2, 3, & 4)
 3. Drill 8 mm hole. (1 place, location 2)
 4. Drill 10 mm hole. (3 places, location 1, 3 & 4)
 5. Pay attention not to damage the wire harness in the rear hatch when drilling.
 6. Remove burrs from holes, and apply touch up paint or silicone to edges.
 7. Completely remove metal shavings by air blowing and vacuum.
 8. With hatch in down position, remove spoiler plastic stud protectors and carefully align spoiler bolts with holes 2 and 3.

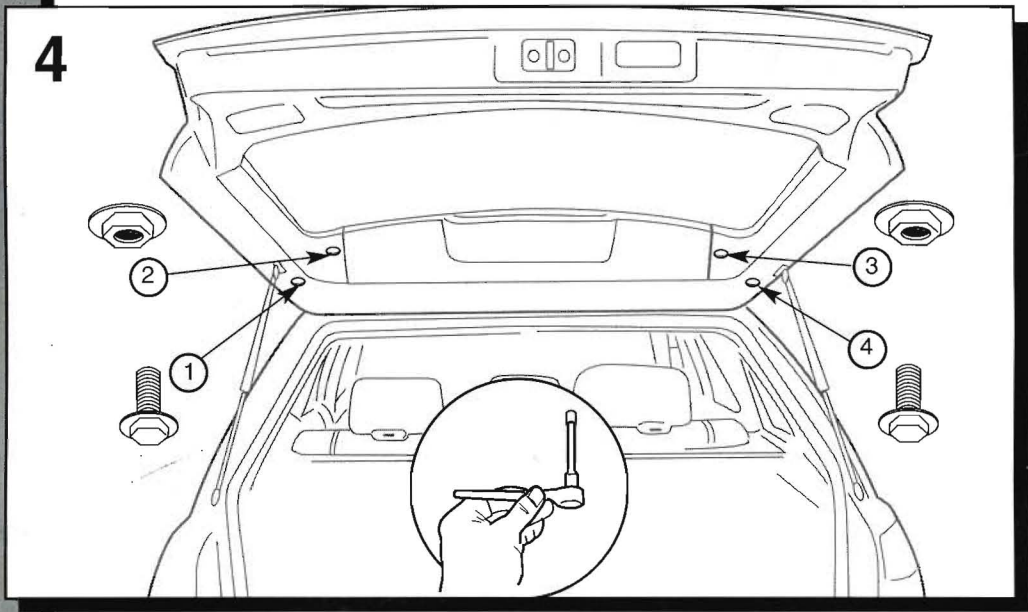

- 4**
1. While standing to the side of the hatch, allow hatch to open slowly while supporting spoiler with free hand.
 2. Holding down the spoiler by hand, install the two (2) 6 mm hex bolts at locations 1 and 4. Do not tighten at this time.
 3. Install the two (2) 6 mm attaching nuts through the access holes at locations 2 and 3. Confirm proper location of spoiler and adjust to center if necessary at this time.
 4. Tighten the 6 mm hex nuts to recommended torque of 5.5Nm or 48 in lbs., using a torque wrench.
 5. Tighten the 6 mm hex bolts to 5.5 Nm or 48 in lbs. (4 ft lbs.).
 6. Install interior trim panels in reverse order of steps 2 and 3 of Section 1.
 7. Installation is complete.

NOTE: It is recommended that this product be installed by a trained Subaru Technician at your local Subaru dealer. If you intend to install this product and you feel that additional detailed instructions might be of benefit to you, please contact your local Subaru dealer for more detailed installation instructions.